

# **VMS Station**

## **Quick Start Guide**



## Notes

- Please read this user manual carefully to ensure that you can use the device correctly and safely.
- There may be several technically incorrect places or printing errors in this manual. The updates will be added into the new version of this manual. The contents of this manual are subject to change without notice.
- All examples and pictures used in the manual are from one of the models for reference purpose.
- This device should be operated only from the type of power source indicated on the marking label. The voltage of the power must be verified before using the same. Kindly remove the cables from the power source if the device is not to be used for a long period of time.
- Do not place this device near any heat sources such as radiators, heat registers, stoves or other devices that produce heat.
- Do not place this device near water. Clean only with a dry cloth.
- Do not block any ventilation openings and ensure proper ventilation around the machine.
- Do not power off the device at normal recording condition.
- This machine is for indoor use only. Do not expose the machine in rain or moist environment. In case any solid or liquid get inside the machine's case, please turn off the device immediately and get it checked by a qualified technician.
- Do not try to repair the device by yourself without technical aid or approval.

# 1 Front & Rear Panel Interfaces

## ● Front Panel

The picture below is for reference only.



Name	Description
REC	Record indicator
NET	Network indicator. The light will go on when it is connected to network.
PWR	Power indicator. The light will go on when it is powered.
	USB interface

## ● Rear Panel

The interfaces of rear panel are for reference only.

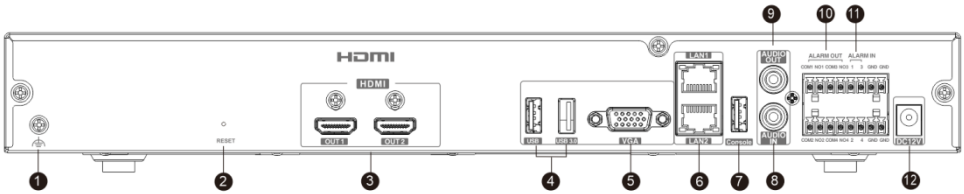

Number	Description
1	Ground
2	Reset: hold and press it for 5 seconds to restore to the factory default settings
3	2 CH HDMI output
4	Connectors for USB devices (like USB mouse, USB storage device)
5	VGA output
6	Gigabit Ethernet port × 2
7	Serial port for debugging
8	Audio input connector

9	Audio output connector
10	4CH alarm output
11	4CH alarm input
12	DC12V power input

## 2 HDD Installation

This series of the product supports 2 SATA hard drives. The pictures of the installation are only for reference. Please make sure that the device is powered off before the installation.

- ① Loosen the screws on the rear panel and both sides to open the cover.
- ② Screw the screws into the holes of HDD, but not tighten them.
- ③ Put the HDDs onto the bottom of the device.
- ④ Turn over the device and secure the HDD with the screws..

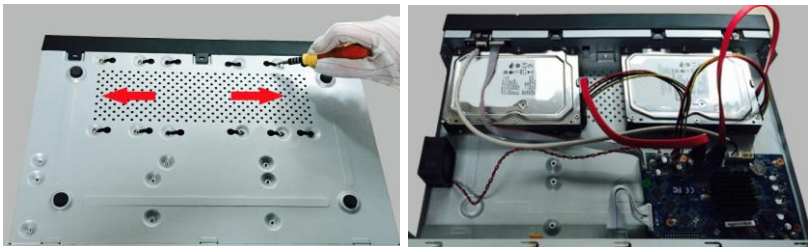

- ⑤ Connect the power and data cables.
- ⑥ Install back the cover and secure it with screws.

**Note:** Before installing the top cover, check all components and cables are well connected.

## 3 Login & Network Configuration

Before starting, please make sure network cable, monitor and power are connected. After the server is started, the following window will appear as shown below.

User Name

Password Forget password?

Remember Password  Auto Login

- ① Enter username and password (the default username is admin; the default password is 123456).
- ② Check “Remember Password” or “Auto Login” as needed.
- ③ Check and read the privacy statement. After that, click [Login].

If you forget the password, please click “Reset password”. Then a small window will appear. You can reset the password by answering the pre-defined questions.

If this is the first time for you to log in, it is recommended to modify the default password and set the security questions/answers.

## ● Network Configuration

After logging in, enter Local Configuration → Network Config interface as shown below.

IP Group  Enable

IP Address   
 Subnet Mask   
 Gateway   
 Network Mode   
 Major DNS   
 Minor DNS

LAN1  Bind static IP  
 MAC Address 58:53:C0:34:04:64  
 IP Address   
 Subnet Mask   
 Gateway

LAN2(Offline)  Bind static IP  
 MAC Address 58:53:C0:34:04:65  
 IP Address   
 Subnet Mask   
 Gateway

Set the network parameter according to the actual condition.

You can manually enter the network parameters by checking “Bind static IP” or you can uncheck “Bind static IP” and click “Apply” to automatically get the IP address.

It is recommended to enable “IP Group”.

Then you can add devices and set other parameters as needed. Please refer to the user manual for more details.